

KT-E270F

27" Full HD Surgical Monitor

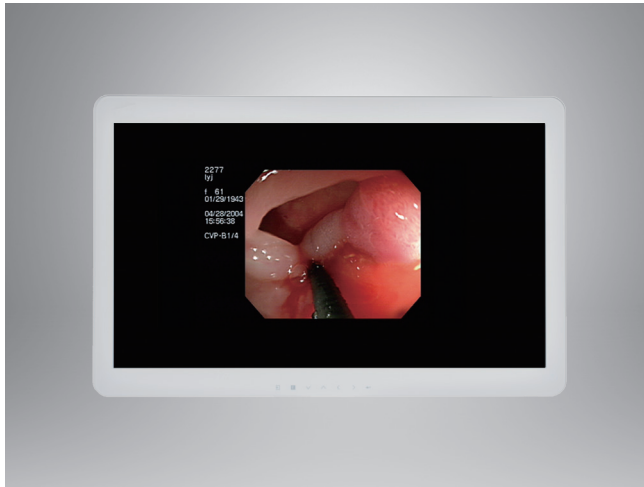

Features

- 27" widescreen with Full HD 1920 x 1080
- Environmentally-friendly LED backlight
- 14-bit LUT (Look Up Table) processing
- DICOM Part 14 compliant
- Wide connectivity including 3G-SDI and single-fiber option interface
- Multi-modality input system

Specifications

Display	Screen Size (Active Area)	27" (597.888(H) x 336.312(V) [mm])
	Aspect ratio	16:9
	Number of Pixels	1920(H) x 1080(V)
	Pixel Pitch	0.3114(H) x 0.3114(V) [mm]
	Displayable Colors	1.07 billion (10-bit)
	Brightness (Typical)	700 cd/m ²
	Contrast Ratio (Typical)	1,000:1
	Display Mode	AFFS
	Response Time (Typical)	14 ms (Gray to Gray)
	Viewing Angle (H/V)	178/178
	Touchscreen	P-CAP (Optional)
	Protection	AR-coated Glass
Power	Power Supply	DC24V, 6.25A (MAX)
	Power Consumption (Typical)	71.4 W
Environment	Temperature	Operational: 0 ~ 50 °C Storage: -20 ~ 60 °C
	Humidity	Operational: Ta = 40 °C , 85% RH Storage MAX 85% RH, Ta = 40 °C
	Altitude	Operational: 0 ~ 16,400 feet (5,000m) Storage/Shipment: 0 ~ 40,000 feet (12,192m)
IP Rating	Front	IP65
	Top	IPX2
Physical Characteristics	Dimension w/o stand	660(W) x 421(H) x 84.5(D) mm
	Net Weight w/o stand	7.6 kg
	VESA Mount	100 x 100mm
Features	Grayscale Performance	14-bit LUT (Look Up Table) processing Standard GSDF included (DICOM Part 14 Compliant)
	DICOM	Clear, Blue Mode support Variable Gamma and DICOM (Color Temp) mode
Signals	Input	RS232C Jack x1 for service port, Displayport (1.2) x1, HDMI x1, DVI-D x2, 3G-SDI (BNC) x2, RGB/SOG (D-sub) x1, RGB/SOG (BNC) x1, Component (BNC) x1, S-video x1, Video (BNC) x1
	Output	DVI-D x2, 3G-SDI (BNC) x2, RGB/SOG (D-sub) x1 RGB/SOG (BNC) x1, Component (BNC) x1, S-video x1, Video (BNC) x1
Certifications		CE MDD 93/42/EEC (EN60601-1-2:2006; EN60601-1-2:2007), FCC CLASSA, UL, KC, VCCI CLASSA, RoHS II
Warranty		3 years

Dimensions

Unit: mm

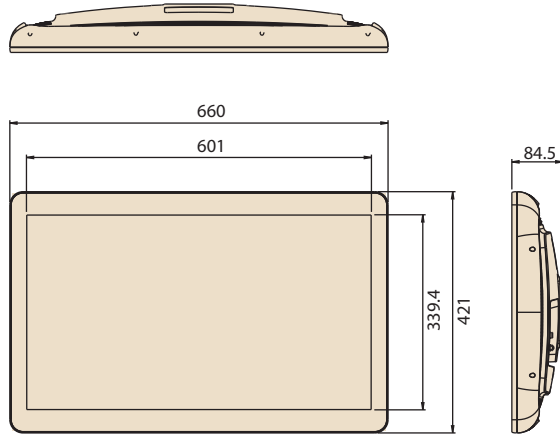

I/O Ports

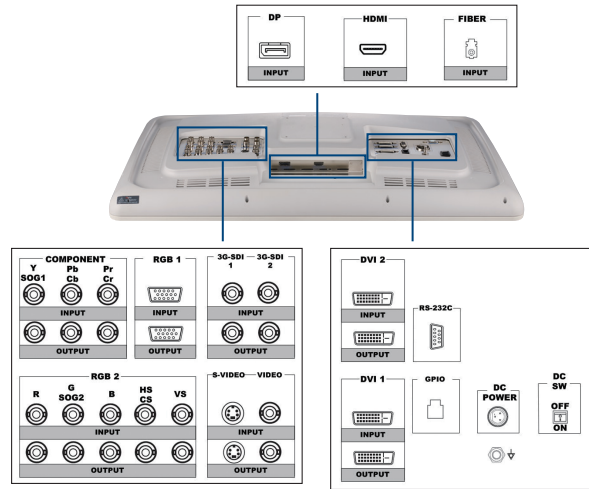

Order Information

Part Number	Resolution	Brightness	Touchscreen
KT-E270FBEQBTF	1920 x 1080	700 cd/m ²	No
KT-E270FBEQJTF	1920 x 1080	700 cd/m ²	P-CAP

Accessories

Accessories	Specifications
Standard	Owner's Instruction, Adapter AC/DC, Power Cord Stand, DP Cable, HDMI Cable, DVI Cable, VGA D-SUB Cable, VGA BNC Cable, SDI BNC Cable
Option	Optical Cable, FIBER TX, Component BNC Cable, S-Video Cable, Video BNC Cable

Front Function Keys

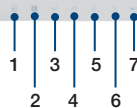

- (1) Input Button
- (2) PIP Button
- (3) Down Button
- (4) Up Button
- (5) Left Button
- (6) Right Button
- (7) Menu Button

I/O Ports		Specifications
DP Input	DP Jack x 1	DisplayPort 1.2 MAX: 1920 x 1080 / 60 Hz
HDMI Input	HDMI Jack x 1 (Type A)	Digital RGB: TMDS MAX: 1920 x 1080 / 60 Hz
FIBER Input	LC Jack x 1 (Option)	Multi Mode Fiber MAX: 1920 x 1080 / 60 Hz
Component / SOG Input	BNC Jack x 1	Y(SOG):1V[p-p](75Ω), Pb/Cb:0.7V[p-p](75Ω), Pr/Cr:0.7V[p-p](75Ω), 480i, 576i, 480p, 576p, 720p, 1080i, 1080p
Component / SOG Output	BNC Jack x 1	Y(SOG):1V[p-p](75Ω), Pb/Cb:0.7V[p-p](75Ω), Pr/Cr:0.7V[p-p](75Ω), 480i, 576i, 480p, 576p, 720p, 1080i, 1080p
RGB / SOG Input	D-Sub Jack x 1 BNC Jack x 1	Analog RGB: 0.7V[p-p](75Ω), H/CS/V: TTL (2.2 kΩ), SOG: 1V[p-p](75Ω), MAX: 1920 x 1080 / 60 Hz
RGB / SOG Output	D-Sub Jack x 1 BNC Jack x 1	Analog RGB: 0.7V[p-p](75Ω), H/CS/V: TTL (2.2 kΩ), SOG: 1V[p-p](75Ω), MAX: 1920 x 1080 / 60 Hz
SDI Input	BNC Jack x 2	Serial Input Common Mode: 2.2V[p-p](75Ω) MAX: 1920 x 1080 / 60 Hz (3G-SDI)
SDI Output	BNC Jack x 2	Serial Output Common Mode: 2.2V[p-p] (75Ω) MAX: 1920 x 1080 / 60 Hz (3G-SDI)
S-Video Input	Mini DIN Jack x 1 (4 pin)	Y: 1V[p-p] (75 Ω), C: 0.286V[p-p] (75 Ω) [NTSC] Y: 1V[p-p] (75 Ω), C: 0.300V[p-p] (75 Ω) [PAL / SECAM]
S-Video Output	Mini DIN Jack x 1 (4 pin)	Y: 1V[p-p] (75 Ω), C: 0.286V[p-p] (75 Ω) [NTSC] Y: 1V[p-p] (75 Ω), C: 0.300V[p-p] (75 Ω) [PAL / SECAM]
Video Input	BNC Jack x 1	1V[p-p] (75 Ω) [NTSC / PAL / SECAM]
Video Output	BNC Jack x 1	1V[p-p] (75 Ω) [NTSC / PAL / SECAM]
DVI Input	DVI Jack x 2 (Type D)	Digital RGB: TMDS MAX: 1920 x 1080 / 60 Hz
DVI Output	DVI Jack x 2 (Type D)	Digital RGB: TMDS MAX: 1920 x 1080 / 60 Hz
GPIO	RJH-4 Jack x 1	General Purpose Input and Output(GPIO): TTL
RS-232C	D-Sub Jack x 1	Service Port
DC Power Input	DC Jack x 1	DC24V, 6.25A(MAX)